

## 履带销密封解决方案

## TRACK PIN SEALING SOLUTION

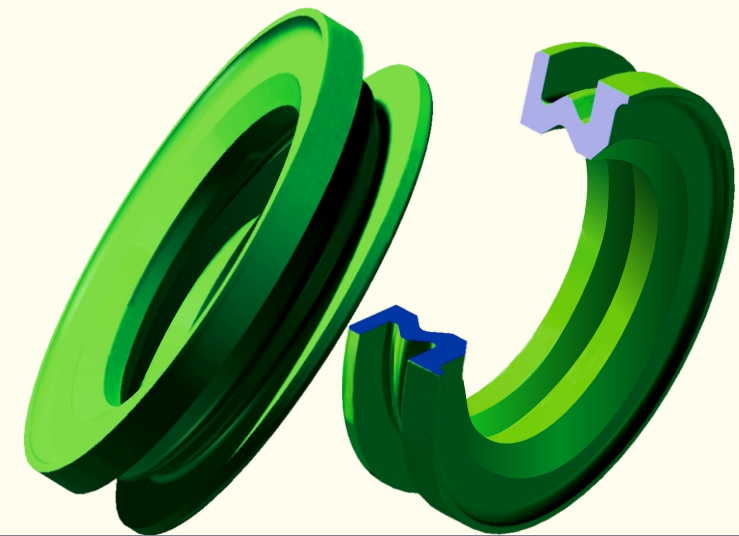

Professional manufacturer of engineered polymer products



苏州普力密封科技有限公司  
Suzhou Pulim Sealing Technology Co., Ltd

地址: 中国苏州市相城区经济开发区华阳路155号  
Address: No.155 Huayang Road,Xiangcheng District, , Suzhou , P.R. China  
Tel: +86 (512) 66333588 Fax: +86 (512) 66333988  
网址: www.pulim.cn



优泰科（苏州）密封技术有限公司  
UTEC (Suzhou) Sealing Solutions Co., Ltd

地址: 中国苏州工业园区界浦路南 江田里路25号  
Address: No.25 JiangTianLi road, south JiePu road, SIP,215126 Suzhou,P.R.China  
Tel: +86 (512) 62795018 Fax: +86 (512) 62797880  
网址: www.utecc.com

苏州普力密封科技有限公司  
Suzhou Pulim Sealing Technology Co., Ltd  
优泰科（苏州）密封技术有限公司  
UTEC (Suzhou) Sealing Solutions Co., Ltd

## 履带销密封的应用

### Application Of Track Pin Seal

Track chassis is an important part of construction machinery, is composed of track chain, support wheel, driving wheel, guide wheel, drag sprocket.

Track chain is composed of track plate, chain rail section, pin sleeve, seal. Track pin connects each chain rail to form track chain link.

Track chain is widely used in engineering, mine, port, sanitation and other equipment, the working environment is bad. As the core component unit of track chain, track pin seal directly determines the service life of track.



The functional realization of track pin seal depends on the material and product design



Sealing Properties

Dustproof Properties

Waterproof Properties

#### Waterproof Properties

- ① Waterproof Properties
- ② Adapt to a large temperature range
- ③ Strong hydrolysis resistance
- ④ Strong grease resistance

#### Strong grease resistance

- ① Excellent performance of permanent compression deformation
- ② Excellent wear resistance
- ③ Long use time



## 普力履带销密封专用材料

### Pulim Track Pin Special Sealing Material

Pulim Seal specializes in the development of high hardness polyurethane materials for track pin seal.

性能 / Properties	单位 / Unit	聚氨酯 / PLMPUR-E	测试标准 / Test standard
硬度 / Hardness	Shore A	96 +-2	DIN ISO 7619
比重 / Density	g/cm <sup>3</sup>	1,20	DIN EN ISO 1183-1
拉伸强度 / Tensile @100%	Mpa	≥13	DIN 53504
拉伸强度 / Tensile @300%	Mpa	≥16	DIN 53504
拉伸强度 / Tensile @yield	Mpa	≥35	DIN 53504
伸长率 / Elongation	%	≥420	DIN 53504
压变 / Compression set 24 h / 70°C	%	≤20	DIN ISO 815
压变 / Compression set 70 h / 70°C	%	≤23	DIN ISO 815
回弹率 / Reboud	%	≥35	DIN53512-2000
磨耗 / Abrasion 10N/40M/84R	mm <sup>3</sup>	≤30	DIN53516
应用温度 / Service Temperature	°C	-20 ~ 110	ISO11357-2 2020

## 普力履带销密封产品

### Pulim Track Pin Sealing Products

Pulim track seal has good sealing, dust-proof, waterproof and other functions. At the same time, the M-shaped seal structure can play a good elastic compensation function to ensure the stability of the whole system when the track turns or the ground is seriously bumpy.

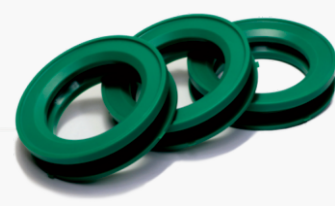
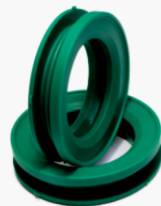

## 普力履带销密封产品的型号

### Model Of Pulim Track Pin Seal Product

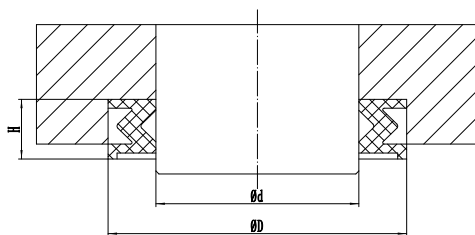
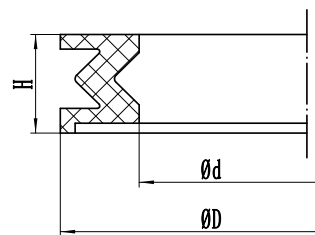

product model	d	D	H
PLM-LD 25.2×37.5×9.2 PUR-E	24.5	41.4	10.3
PLM-LD 24.5×41.4×10.3 PUR-E	25.2	37.5	9.2
PLM-LD 28.5×46.5×11.9 PUR-E	28.5	46.5	11.9
PLM-LD 29×47×10.3 PUR-E	29	47	10.3
PLM-LD 30.6×46.5×10.5 PUR-E	30.6	46.5	10.5
PLM-LD 32.5×48.4×12.1 PUR-E	32.5	48.4	12.1
PLM-LD 32.5×50.6×11.7 PUR-E	32.5	50.6	11.7
PLM-LD 34×50.9×10.7 PUR-E	34	50.9	10.7
PLM-LD 37×59×14.5 PUR-E	37	59	14.5
PLM-LD 37.3×58.8×14.3 PUR-E	37.3	58.8	14.3
PLM-LD 37.3×59.6×13.2 PUR-E	37.3	59.6	13.2
PLM-LD 37.5×59×13 PUR-E	37.5	59	13
PLM-LD 38.8×58.5×14.5 PUR-E	38.8	58.5	14.5
PLM-LD 38.85×59.6×14.3 PUR-E	38.85	59.6	14.3
PLM-LD 39.5×59×13 PUR-E	39.5	59	13
PLM-LD 45.2×67.3×13.6 PUR-E	45.2	67.3	13.6
PLM-LD 45.4×67.2×13.5 PUR-E	45.4	67.2	13.5
PLM-LD 47.6×71.5×13.6 PUR-E	47.6	71.5	13.6
PLM-LD 48×72×12 PUR-E	48	72	12
PLM-LD 49.5×77.3×15 PUR-E	49.5	77.3	15
PLM-LD 50×79×12.5 PUR-E	50	79	12.5
PLM-LD 58.2×86.4×16.5 PUR-E	58.2	86.4	16.5